

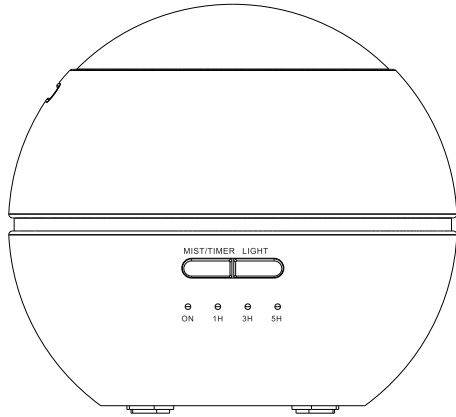

Misting Dome Operating Instructions



Imported by: Mariner Packaging Company Ltd

MADE IN P.R.C.

www.PowAir.co.uk / Sales@PowAir.co.uk / 01472 426 500



PowAir Misting Dome

Parts

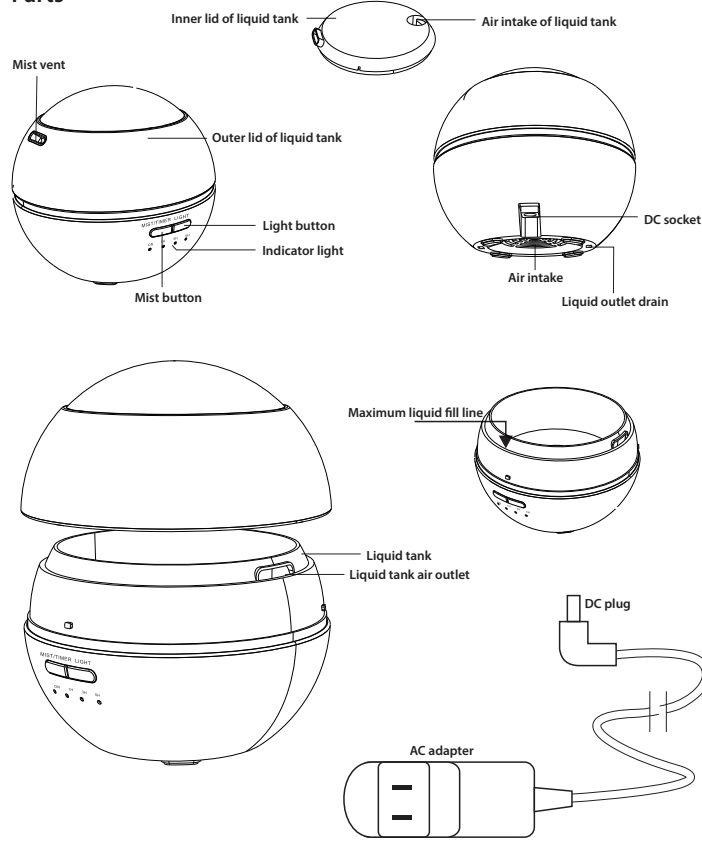

Images are for illustration purposes only, actual product may vary.



PowAir Misting Dome

Operating Manual for PowAir Misting Dome

1. Straighten the Misting Dome (position the lid at the top, facing upwards), push open the lid and fill with liquid. If there is liquid in the tank, do not tilt the product.
2. Plug the DC end of AC adapter into DC socket of the Misting Dome.

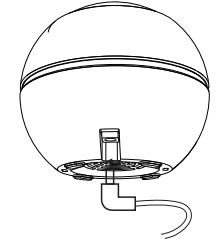
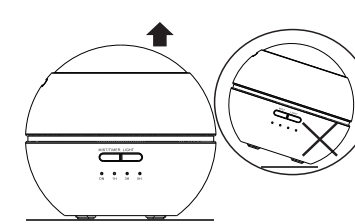

3. Do not fill beyond the maximum fill line, as indicated. Avoid pouring any liquid outside of the water tank. Do not fill while product is in use. Do not attempt to fill with hot water.

4. Keep the Misting Dome level while filling with liquid, after the tank is full, carefully place it on to a flat and level surface.

Do not fill over the max fill line.

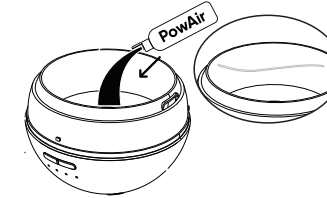

5. Cover the lid and then fasten it onto the tank, do not tilt the unit. Liquid in the tank is liable to spill out when tilting due to the structural character of the product. If tilting occurs, liquid in the tank may flow into the inner electric circuit of the product, which may cause malfunction.

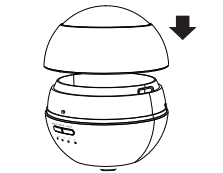

6. Connect the plug end of the AC adapter to a household power socket, the Misting Dome beeps once when powered on. (Only use the AC adapter provided).

7. Confirm that the machine is powered on, that the liquid level is within range and that the product lid is closed. Push the misting button and select a light colour. Enjoy your misting dome!

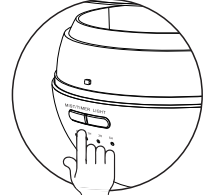
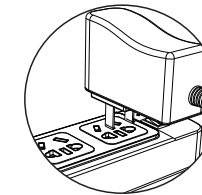



Instructions for the Misting Dome functions:

1. Press the mist button for a short while, the misting function will be activated (The default setting is for continuous mist). Press the misting button again to switch between timed hourly, 3 hourly and 5 hourly misting modes. The current mode will be indicated by an LED status light. Press and hold the mist button to de-activate the misting function.

2. If the liquid tank is empty, or below the minimum level, the sensor will automatically turn off the misting function. To continue misting, refill the liquid tank and press the mist button for a short while, misting will be reactivated.

3. Light button: press the light button for a short while to activate the LED Lighting mode. Once active, press the light button again to select an individual colour. There are 8 colours to choose from, pressing the light button will cycle through the colours. Press and hold the light button to de-activate the lighting function. (Light function can be used without the misting mode being active)

Product parameters:

Product name: PowAir Misting Dome	Spraying mode: push for a short while for 1H/3H/5H
Product size: 12*12*10.8cm	Power of the main body: ≤10W
Net weight: 200g	Atomizing vibrating frequency: 2.4MHz
Power: standard dedicated adapter	Using area: 10-15 sqm, appr.
Input of the adapter: AC100-240V~50/60Hz 0.4A Max	Effective volume of the tank: 150ml appr.
Output of AC adapter: DC 24V/0.6A	Major material: PP, ABS, PVC
Rated power of the adapter: ≤14.5W	Production place: Shenzhen, China

Accessory: dedicated adapter, operation manual

Unscrew the top lid from the bottom half and set aside.

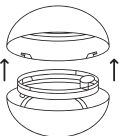

Pour the PowAir Liquid into your Misting Dome and fasten the top lid with the bottom.

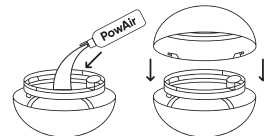

Plug in your dome, set the timer and lighting and you're good to go!

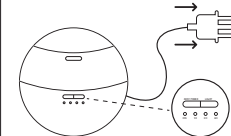

Please read the safety precautions carefully, if safety is neglected, improper use of the Misting Dome could cause harm and damage the product.



Safety Precautions. Please follow this guide carefully.

Do not use the Misting Dome on a slope or in un-steady places.

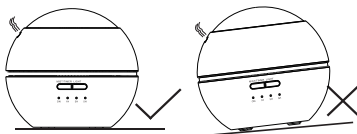

If liquid flows into the air inlet by accident when using the Misting Dome, turn off the power immediately, lay the main body flat, let the liquid drain off from the liquid outlet drain and dry the inner areas before re-use.

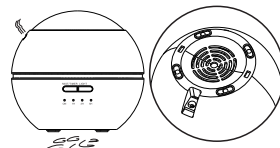

Do not attempt to disassemble, modify or repair the product.

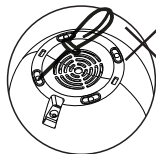

This product is not a medical ventilator; mist sprayed from the unit should not be directly inhaled.

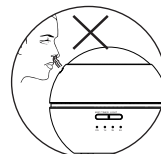

Please do not scratch, bend, warp or pull the wire that is connected to the power adapter. Please do not subject the wire to high temperatures. Please do not grind the wire with heavy objects. If the adapter is damaged, please do not continue using.

Maintenance: please use a neutral household detergent to clean the product. Do not use harsh detergents. Any detergent residuals within the water tank should be avoided as harmful gas or other malfunctions may occur during use.

If maintenance or liquid filling is required, please remove the power adapter from the socket. Do not attempt to remove the power adaptor with wet hands.



Please do not place the product within reach of children. Do not block the air inlet or outlet of the Misting Dome.

If maintenance is needed, or the liquid in the tank needs to be drained, please follow the instructions for draining the tank from the manual. Improper operation may cause the liquid to flow into the main machine areas and damage the circuit board.

Please do not touch the ultrasonic atomizer plate by hand or with hard objects as damage may occur.